

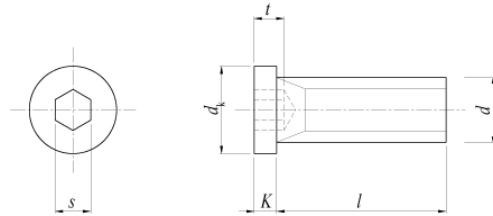

頭部の小さいねじ仕様表

— 極低頭小頭ボルト (鋼製 (黒染)) —



■ 代表品番 : KEH ■ 材質 : SCM435 ■ 駆動部の形状 : 六角穴

| d | M3 | M4 | M5 | M6 | M8 | M10 | |
|-----------|-----|---------|---------|---------|---------|---------|---------|
| d_k | 4.5 | 5.5 | 7 | 8.5 | 10 | 13 | |
| k | 1.3 | 1.5 | 1.5 | 1.5 | 1.5 | 1.5 | |
| s | 1.5 | 2 | 3 | 3 | 4 | 5 | |
| t_{max} | 2 | 2.5 | 3 | 4 | 5 | 5 | |
| l | 5 | KEH0305 | | | | | |
| | 6 | KEH0306 | KEH0406 | | | | |
| | 8 | KEH0308 | KEH0408 | KEH0508 | KEH0608 | | |
| | 10 | KEH0310 | KEH0410 | KEH0510 | KEH0610 | KEH0810 | |
| | 12 | KEH0312 | KEH0412 | KEH0512 | KEH0612 | KEH0812 | KEH1012 |
| | 16 | | KEH0416 | KEH0516 | KEH0616 | KEH0816 | KEH1016 |
| | 20 | | KEH0420 | KEH0520 | KEH0620 | KEH0820 | KEH1020 |
| | 25 | | | KEH0525 | KEH0625 | KEH0825 | KEH1025 |
| 30 | | | | | KEH0830 | KEH1030 | |