

ボルト

概要 超極低頭 | ステンレス鋼製

詳細 ■材質：A2 (JIS B 1054-1 鋼種区分)

代表品番 **SSH**

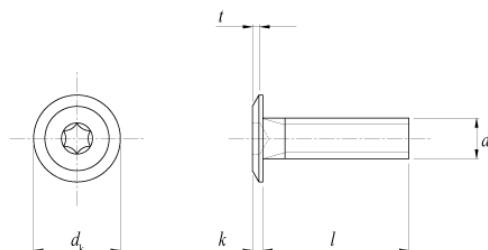

d	M2	M2.6	M3	M4	M5	M6	
d_k	4	6	7	8	9	12	
k	0.5	0.6	0.8	0.9	1	1.2	
t_{min}	0.4	0.5	0.75	0.9	1	1.2	
穴の番号	4	5	6	8	10	20	
l	4	SSH0204	SSH2604				
	5	SSH0205	SSH2605	SSH0305			
	6	SSH0206	SSH2606	SSH0306	SSH0406		
	8	SSH0208	SSH2608	SSH0308	SSH0408	SSH0508	SSH0608
	10	SSH0210	SSH2610	SSH0310	SSH0410	SSH0510	SSH0610
	12	SSH0212	SSH2612	SSH0312	SSH0412	SSH0512	SSH0612
	16			SSH0316	SSH0416	SSH0516	SSH0616
	20				SSH0420	SSH0520	SSH0620
	25				SSH0425	SSH0525	SSH0625
	30					SSH0530	SSH0630
	35						SSH0635
40						SSH0640	