

超極低頭ボルト

概要 十字穴付き | ステンレス鋼製
 詳細 ■ 材質：A2 (JIS B 1054-1 鋼種区分)

代表品番 **SPSH**

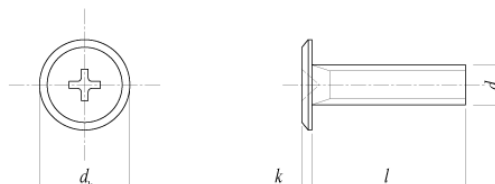

d	M3	M4	M5	M6	
d_k	6	8	9	10	
k	0.9	1.1	1.2	1.3	
穴の番号 (H形十字穴)	1	2	2	2	
l	8	SPSH0308			
	10	SPSH0310	SPSH0410	SPSH0510	
	12	SPSH0312	SPSH0412	SPSH0512	SPSH0612
	16	SPSH0316	SPSH0416	SPSH0516	SPSH0616
	20	SPSH0320	SPSH0420	SPSH0520	SPSH0620
	25	SPSH0325	SPSH0425	SPSH0525	SPSH0625
	30	SPSH0330	SPSH0430	SPSH0530	SPSH0630