

小頭ボルト

概要 鋼製（黒染）

詳細 ■材質：SCM435 ■駆動部の形状：六角穴

代表品番 **KCS**

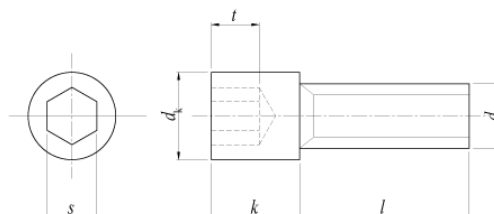

d	M3	M4	M5	M6	M8	M10	M12	
d_k	4.5	5.5	7	8.5	10	13	16	
k	3	4	5	6	8	10	12	
s	2.5	3	4	5	6	8	10	
t_{max}	1.5	2	2.5	3	4	5	6	
l	5	KCS0305						
	6	KCS0306	KCS0406	KCS0506				
	8	KCS0308	KCS0408	KCS0508	KCS0608			
	10	KCS0310	KCS0410	KCS0510	KCS0610	KCS0810		
	12		KCS0412	KCS0512	KCS0612	KCS0812		
	16		KCS0416	KCS0516	KCS0616	KCS0816	KCS1016	
	20		KCS0420	KCS0520	KCS0620	KCS0820	KCS1020	KCS1220
	25				KCS0625	KCS0825	KCS1025	KCS1225
	30					KCS0830	KCS1030	KCS1230
	35						KCS1035	