

低頭小頭ボルト

概要 鋼製（黒染）

詳細 ■材質：S45C ■強度区分：8.8 ■駆動部の形状：六角穴

代表品番 **KLH**

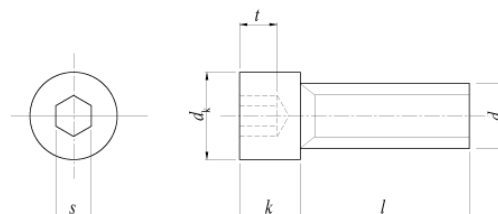

d	M3	M4	M5	M6	M8	M10	M12	
d_k	4.5	5.5	7	8.5	10	13	16	
k	2	2.8	3.5	4	5	6	7	
s	2	2.5	3	4	5	6	8	
t_{max}	1.5	2.3	2.7	3	3.8	4.5	5	
l	5	KLH0305						
	6	KLH0306	KLH0406	KLH0506				
	8	KLH0308	KLH0408	KLH0508	KLH0608			
	10	KLH0310	KLH0410	KLH0510	KLH0610	KLH0810		
	12		KLH0412	KLH0512	KLH0612	KLH0812		
	16		KLH0416	KLH0516	KLH0616	KLH0816	KLH1016	
	20		KLH0420	KLH0520	KLH0620	KLH0820	KLH1020	KLH1220
	25				KLH0625	KLH0825	KLH1025	KLH1225
	30					KLH0830	KLH1030	KLH1230
	35						KLH1035	